

## New Battery cabinet offering

*New Battery cabinets, central offering from Helsinki Plant (HPO)*

This Sales Bulletin contains important information about the new battery cabinets that are available centrally from HPO.

There will be two new battery cabinets available, which can be used with the 93PM 30-200kW. The following chapters will explain the Small battery cabinet and Large battery cabinet offering in detail.

### Contents

Battery breaker sizing for 93PM product line .....	1
Small battery cabinet .....	1
Large battery cabinet .....	2

## Battery breaker sizing for 93PM product lines

Please refer to the below Table 1 for battery breaker sizing for 93PM product lines, which should be used as a reference when selecting the battery cabinet and DC breaker. The DC breaker is included in the battery cabinet.

### 1 Battery DC Breaker sizing.

DC (Battery) Breaker rating	93PM range
200A	93PM 30-50kW
400A	93PM 80-100kW
500A	93PM 120-150kW
700A	93PM 160-200kW

## Small battery cabinet

The part numbers for small battery cabinets are listed in Table 2. The offering includes empty battery cabinets, which include also battery interconnect cables and battery-to-UPS cables (50mm<sup>2</sup> with 200A breaker cabinet and 95 mm<sup>2</sup> with 400A breaker cabinet).

The battery types, which are currently available from HPO for this cabinet, include CSB HRL 110W and CSB HRL 200W batteries. **These batteries will ship ready installed inside the cabinet.**

The battery interconnect cables include two different cable lugs.

- M5 cable lugs, used with smaller batteries such as CSB HRL110W and FIAMM FLB100.
- M6 cable lugs, used with batteries such as CSB HRL200W and FIAMM FLB200.

## 2 Small Battery Cabinet offering.

DC (Battery) Breaker	Part Number	Description	Battery
<b>200A</b>	P-105000017-001	93P/E-BAT-S-0x36-EMPTY (200A) M5 cables	Empty. Interconnect cables for 36 blocks.
<b>200A</b>	P-105000017-005	93P/E-BAT-S-0x36-EMPTY (200A) M6 cables	Empty. Interconnect cables for 36 blocks.
<b>200A</b>	P-105000017-002	93P/E-BAT-S-1x36-110W (200A)	36 x CSB HRL 110W
<b>200A</b>	P-105000017-004	93P/E-BAT-S-1x36-200W (200A)	36 x CSB HRL 200W
<b>400A</b>	P-105000018-001	93P/E-BAT-S-0x40-EMPTY (400A) M6 cables	Empty. Interconnect cables for 40 blocks.
<b>400A</b>	P-105000018-002	93P/E-BAT-S-1x36-200W (400A)	36 x CSB HRL 200W
<b>400A</b>	P-105000018-003	93P/E-BAT-S-1x40-200W (400A)	40 x CSB HRL 200W

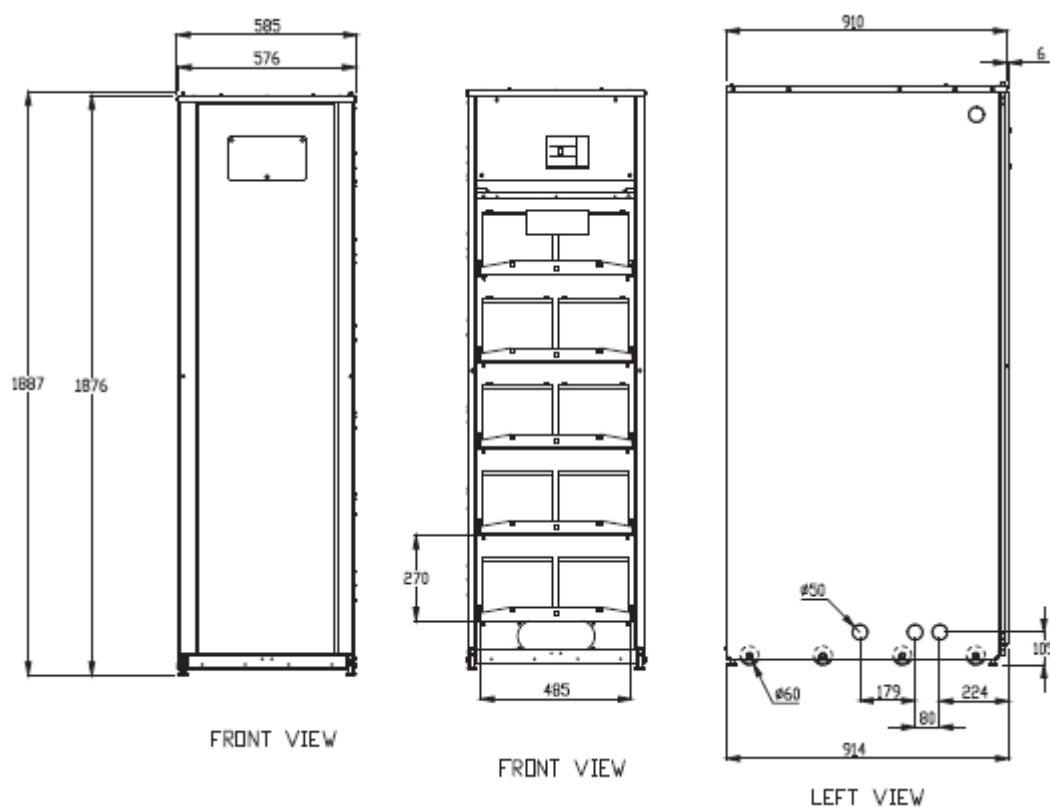

Figure 1 Small Battery Cabinet

## Large battery cabinet

The part numbers for large battery cabinets are listed in Table 3. The offering is comprised of empty battery cabinets, including also the battery interconnect cabling for up to 40 blocks. Cabinet-to-UPS cables are not included.

The battery interconnect cables include two different cable lugs.

- M6 cable lugs, used with CSB and Exide batteries.
- M8 cable lugs, used with FIAMM batteries.

## Note!

Due to the mechanical structure of the cabinet and the considerable weight of the large capacity batteries, this Large Battery Cabinet **cannot be shipped or moved when batteries are installed inside the cabinet**. The batteries will always need to ship in a separate pallet, and battery installation will always need to be done at the site of installation. Therefore, only empty Large Battery Cabinets are included in the 3ph UPS Price List.

### 3 Large Battery Cabinet offering.

DC (Battery) Breaker	Part Number	Description
<b>400A</b>	P-105000035-001	93P/E-BAT-L-EMPTY (400A) M6 cable lugs
<b>400A</b>	P-105000035-002	93P/E-BAT-L-EMPTY (400A) M8 cable lugs
<b>500A</b>	P-105000036-001	93P/E-BAT-L-EMPTY (500A) M6 cable lugs
<b>500A</b>	P-105000036-002	93P/E-BAT-L-EMPTY (500A) M8 cable lugs
<b>700A</b>	P-105000037-001	93P/E-BAT-L-EMPTY (700A) M6 cable lugs
<b>700A</b>	P-105000037-002	93P/E-BAT-L-EMPTY (700A) M8 cable lugs

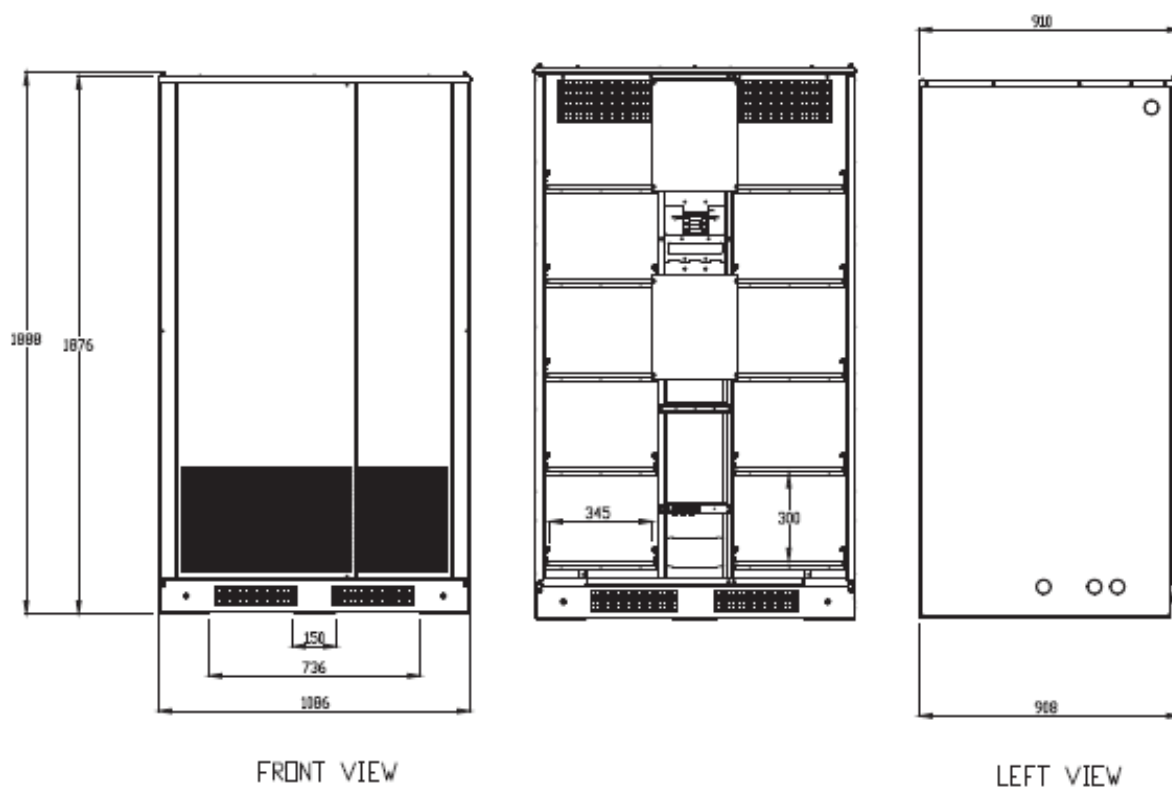

Figure 2 Large Battery Cabinet